



Model iIS-BF4 Smart Camera Processor Connects
Up To Four Color or B/W FireWire Cameras



SmartDragon

Key Features

FIREWIRE-B COMPATIBLE: SmartDragon iIS-BF4 can connect and simultaneously receive up to four IEEE1394.b cameras, taking maximum advantage of FireWire B transfer speed. It supports both color and black-and-white cameras.

SIXTEEN I/O's: SmartDragon features 16 insulated digital input and output terminals to serve the widest range of industrial applications including food and beverage, pharmaceutical, packaging, semiconductors and other areas. The external trigger input terminal can be used to input signals at the desired timing with variations in delay times and pulse widths. This signal can then be output from the external trigger output terminal

STANDARD INTERFACES: SmartDragon sends and receives setting information and data via RS-232C, USB or Ethernet.

HDD-LESS SYSTEM: SmartDragon uses large capacity CF cards to realize robust, shock resistant performance with higher reliability

WINDOWS® COMPATIBLE: SmartDragon is compatible with software applications designed to run on Microsoft® Windows XP® Professional SP2.

SDK AND VIEWER SOFTWARE Download TeliDCAM software for IEEE-1394.b cameras at www.toshiba-teli.com. PC-Tri32 also included.

Specifications

Processor	Pentium® M 1.4GHz
RAM	DDR2, 533 MHz, 512 MB
Storage	Industrial CF Card (4 GB max) x 2 slots including 1 internal slot
VGA	Mini Dsub 15-pin 1600 x 1200, 1280 x 1024, 1024 x 768, 800 x 600 24-bit
Keyboard/Mouse (w/splitter)	PS2 x 1
Camera Interface	IEEE1394.b x 4 channels (for cameras only)
Network Interface	1000Base-T, 100Base-TX, 10Base-T x 1
USB Interface	USB 2.0 x 2 channels
Serial Interface	RS-232C Dsub 9-pin (male) x 2 channels
OS	Microsoft Windows XP Embedded SP2 SP2-applied Japanese MUI installed .NET Framework 2.0 installed TeliDCAM, PC-Tri32 installed Sample software for capture iIS Utility Tools
Output Pixels	Depends of camera specifications
Maximum Frame Speed	Depends of camera specifications
Temperature	°32F - 104° F (20-80% Humidity)
Power Source	100 to 240 VAC, 50/60 Hz Input voltage to unit: 12 VDC
Power Consumption	60W (12 VDC)
Dimensions	193(W) x 88(H) x 181(D) mm 1.73(W) x 1.14(H) x 2.56(D) inches
Weight	2300g
Standards	CE, FCC (Part 15 Class A) EMC Condition, EMI
Compatible Cameras	Toshiba Teli FireDragon™ Cameras
Black-and-White	CSFV90BC3, CSFX36BC3, CSFS20BC3, CSFU15BC18
Color	CSFV90CC3, CSFX36CC3, CSFS20CC2, CSFU15CC18

Example of Operating Environment

Below is an example of connecting devices to the iIS-BF4 image processing equipment.

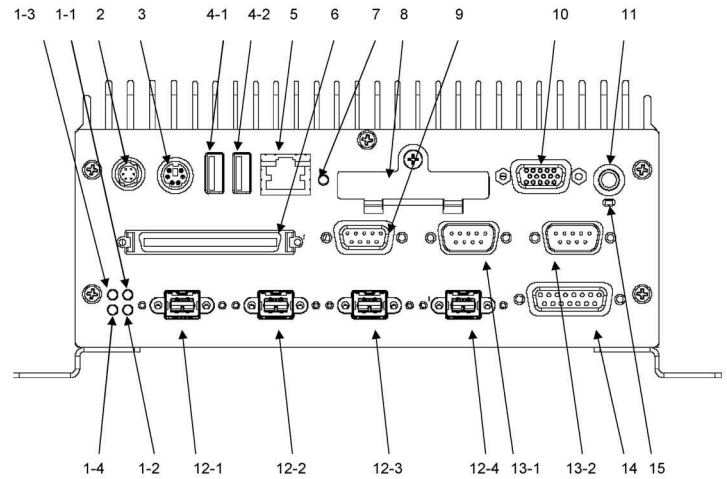
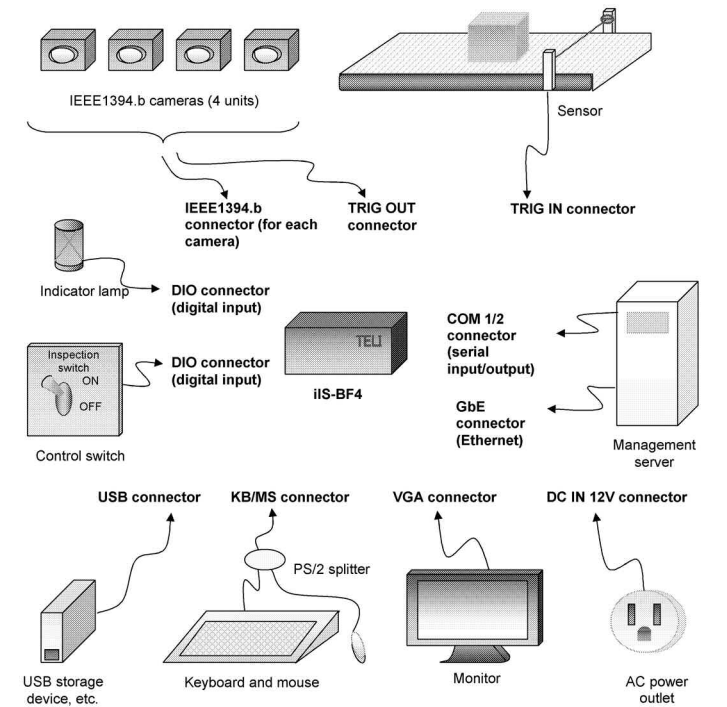

- | | |
|-----------------------------|---------------------------------------|
| 1: Indicator lights (4) | 9: External trigger input connector |
| 2: DC Connector | 10: Display connector |
| 3: PS/2 Connector | 11: Power switch |
| 4: USB 2.0 connectors (2) | 12: IEEE1394.b connectors (4) |
| 5: Ethernet connector RJ-45 | 13: RS-232C connector |
| 6: Digital input/output | 14: External trigger output connector |
| 7: CF card access indicator | 15: Reset button |
| 8: CF card slot | |



TOSHIBA TELI CORPORATION
7-1, 4-chome Asahigaoka
Hino-shi, Toyko 191-0065 Japan
TEL: +81-042-589-8771
FAX: +81-042-589-8774
www.toshiba-teli.co.jp

TOSHIBA TELI AMERICA, INC.
33 Hammond
Irvine, California 92618 USA
TEL: +1-949-770-TELI(8354)
FAX: +1-949-206-0210
www.toshiba-teli.com

